

Description



Operating your battery bank without good metering is like running your car without any gauges, although possible to do, it's always better to know how much fuel is left in the tank. Defining the amount of energy available in a battery is a complex task since battery age, discharge current and many other factors influence the actual battery capacity. The e-xpert lite uses the same very accurate measurement and calculation systems as the high-end e-xpert pro.

The e-xpert lite selectively displays voltage, charge- and discharge current, consumed amp-hours and remaining battery capacity. Using a clear backlit LCD and an intuitive user interface, all parameters can be recalled with just a button press. A second battery input is also provided to monitor an auxiliary battery. A large bargraph delivers instant state of charge information.

Compared to the e-xpert pro, the e-xpert lite is a more basic instrument, perfectly suited for users focused on accurate state of charge readout and very easy setup.

Features

- ▶ Read your battery bank like a fuel gauge
- ▶ Provides critical information about the status of your battery bank
- ▶ Displays voltage, current, consumed amp-hours and remaining battery capacity
- ▶ Two battery inputs
- ▶ Large backlit LC Display
- ▶ Autosensing battery voltage inputs
- ▶ Quick nut mounting construction
- ▶ Programmable alarm relay
- ▶ Shunt selection capability enables flexible system integration
- ▶ Splash proof frontpanel
- ▶ 500 Amp shunt included
- ▶ CE and e-mark certified
- ▶ 24 month warranty

Applications

- ▶ Recreational vehicles
- ▶ Solar power systems
- ▶ Industrial systems
- ▶ Forklifts
- ▶ Mobile entertainment systems
- ▶ Service vehicles
- ▶ Marine applications
- ▶ Remote homes

Accessories

- ▶ Professional connection kit
- ▶ Quick connection kit

Technical Specifications

Parameter	e-xpert lite	
Supply voltage range	9..35VDC	
Supply current ¹⁾ :	@Vin=24VDC	7mA
	@Vin=12VDC	9mA
Input voltage range (auxiliary battery)	2..35VDC	
Input voltage range (main battery)	0..35VDC	
Input current range ²⁾	-999..+999A	
Battery capacity range	20..999Ah	
Operating temperature range	-20..+50°C	
Readout resolution :	voltage (0..35V)	± 0.1V
	current (0..100A)	± 0.1A
	current (100..999A)	± 1A
	amphours (0..99Ah)	± 0.1Ah
	amphours (100..999Ah)	± 1Ah
	state-of-charge (0..100%)	± 1%
Voltage measurement accuracy	± 0.3%	
Current measurement accuracy	± 0.4%	
Dimensions :	frontpanel	Ø64mm
	body diameter	Ø52mm
	total depth	79mm
	Weight	95gr
Shunt dimensions :	footprint	45 x 87mm
	height	17mm (base) / 35mm (high current screws)
	weight	145gr
Protection class	IP20 (frontpanel only IP65)	
Complies with the following standards	EN50081-1 (EN55022), EN50082-1 (IEC 801-2/3/4, EN61000-4-3), LVD 73/23/EEC (EN60335-1), e4-95/54/EC	

Note: the given specifications are subject to change without notice.

1) Measured with backlight and alarm relay turned off.

2) Depends on selected shunt. With standard delivered 500A/50mV shunt (350A continuous), the range is limited to -600..+600A.

Dimensions

Sideview :

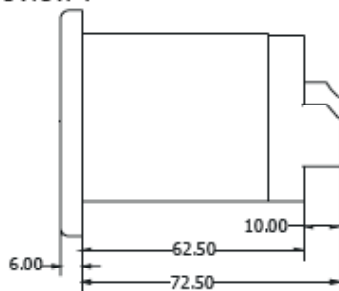

Frontview :



Rearview :

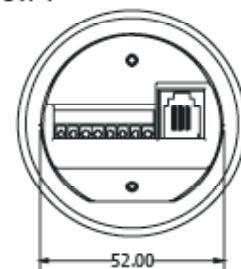

Mounting sequence :

